

PrimeDrive Release Note

Aug 25, 2012 Release

Softbank Telecom Corp.



【1. For Administrator】

- ① Redesigning administrator account
- ② Can be archived for log file
- ③ Changing to New login URL
- ④ Support for Internet Explorer 9

【2. For User】

- ① Support for “Gmail” to send email notification from PrimeDrive
- ② Support for Chinese character of a file name
- ③ Reciever’s email address to send key can be recorded in log file
- ④ Email notification can be sent by “TO”
- ⑤ Adding new preset sharing authority

【3. Others】

- ① Sender’s email address of automatic email notification changed to primedrive.jp.

【In Top Screen】

1. Command button can be placed in upper frame to improve usability

2. You can switch options for searching

3. Add new search condition

The screenshot shows the 'User Search' interface. At the top, there are buttons for 'Add', 'Edit', 'Edit all', 'Delete', 'Emergency Locked', 'File review', 'Import', and 'Export'. Below these is the 'Easy search' section with a 'User ID' field containing 'R006' and an 'Open advanced search' button. A table below shows search results with columns for 'Use ID', 'Name', 'Email', 'Type', 'Capacity', 'Last Login Date', and 'Account Status'. One result is selected. Below the table is the 'Advanced search' section with various filters: 'User ID', 'Name', 'Name Kana', 'Email', 'User type', 'Account Status', 'Last Login Date', 'User Registration Date', 'Workflow use', 'Workflow Approver', 'PKI authentication', 'Shared folders', 'Password Lifetime', and 'Comments'. A 'Search' button and a 'Close advanced search' button are also present.

【Improving usability to edit an user】

The screenshot shows a 'User Search' interface with a table of users. The first row is selected. A callout bubble points to this row with the text: 'Easily access to edit an user screen by double-clicking the record.' To the right, the 'Edit user information' form is displayed, showing fields for User ID, Name, Email, User type, Workflow Approver, Account Status, Password, Password (confirm), Language, and Allocated capacity.

User ID	Name	Email	Type	Cap	
<input checked="" type="checkbox"/>	R006-001	R006-001's C...	yosh...	Corporate Admi...	2.4
<input type="checkbox"/>	user0001	R006-001's u...			0 B...

Easy access to edit an user screen by double-clicking the record.

Administrator needs 3steps to edit an user.1.select record→2.displayed detail→3.Pushing Edit button
Administrator needs only1step to edit an user at new screen.

[NOTE] It is same idea at the list of a user group and log to edit them.

【Adding available capacity】

Service usage

(2012/07/13 13:19 Now)

Contract capacity	1.0 GB
Available capacity	771.6 MB
Used Capacity	252.4 MB
	4.1 MB
	3,001
	8
	9,018
	2
Number of Groups	2
Total Number of AddressBooks	0

*Click [here](#) about allocated capacity and how to check available

Available capacity for the user who is not allocated capacity to his or her account.

In case of allocated space(only 100MB for a user) at contractual capacity(1GB)

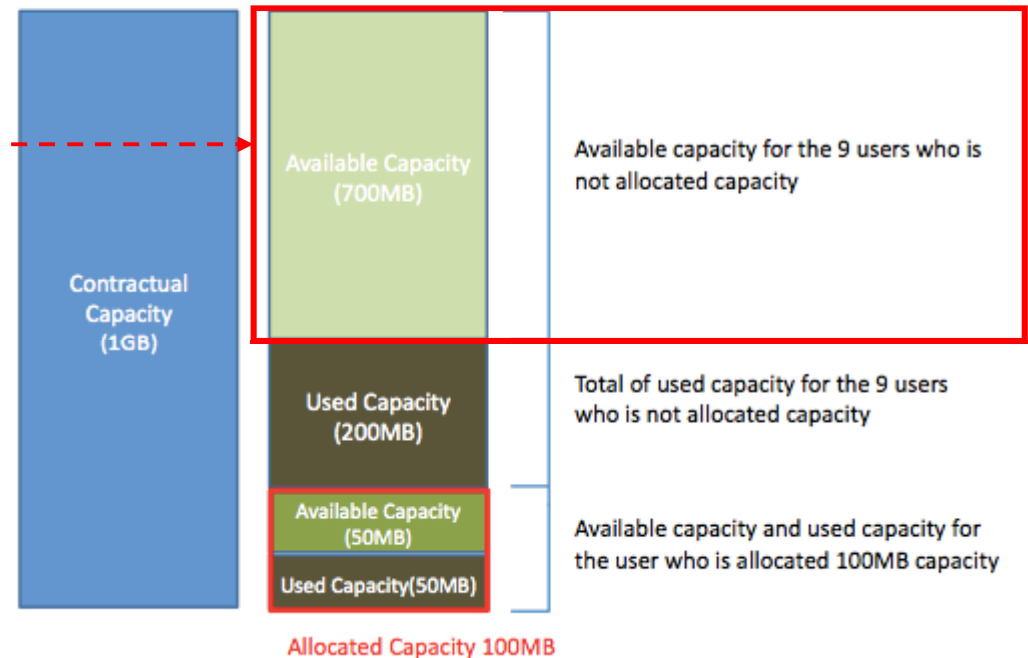

【Supporting for Outlook2010 at when selecting local mailer to send notification email】

Available Devices / Web: Available Not available

Available Devices / iPhone: Available Not available

Available Devices / iPad: Available Not available

Local Mail Settings: Outlook 2007/2010

Administrative account/Archive for log list

•Log data which is older than 5 months is archived. Administrator can download the archived file for each month. The log data which is recorded at last 5months included current month can be searched on screen and download the log file. Log file is archived on every month 1th 0:00.

Log data which is older than 5 months zip download is available for each month

The log data which is recorded at last 5months included current month

<Ex> on July 12th

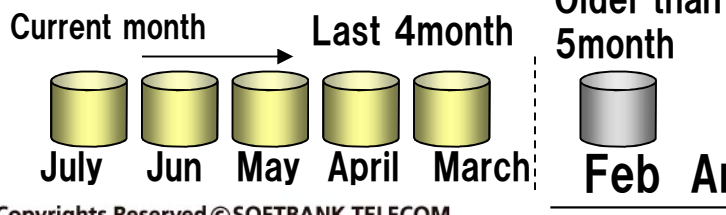

【Current login URL】

https://primedrive.jp/admin/corporate/<CorporateID>

【New login URL】

https://primedrive.jp/admin/<CorporateID>

※You can keep using current login URL to access prime Drive.

We recommend to bookmark new login URL in your browser.

【About corporate policy and IP address restriction function】

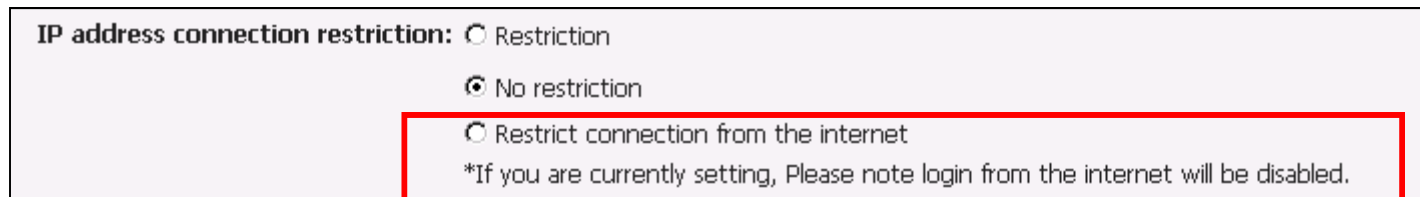

IP address connection restriction: Restriction
 No restriction
 Restrict connection from the internet
*If you are currently setting, Please note login from the internet will be disabled.

“Restrict connection from Internet” is set only for the case of that administrator permitt users to access from SmartVPN/Internet VPN with closed network.

Note: If “Restrict connection from Internet” is set, you can’t access PrimeDrive from Internet.

User account/sending email notification from “Gmail”

- “Send by Gmail” button is added on “Select a Mailer”.
- Title and send key is automatically copied on mail form after clicking “Send by Gmail” button.

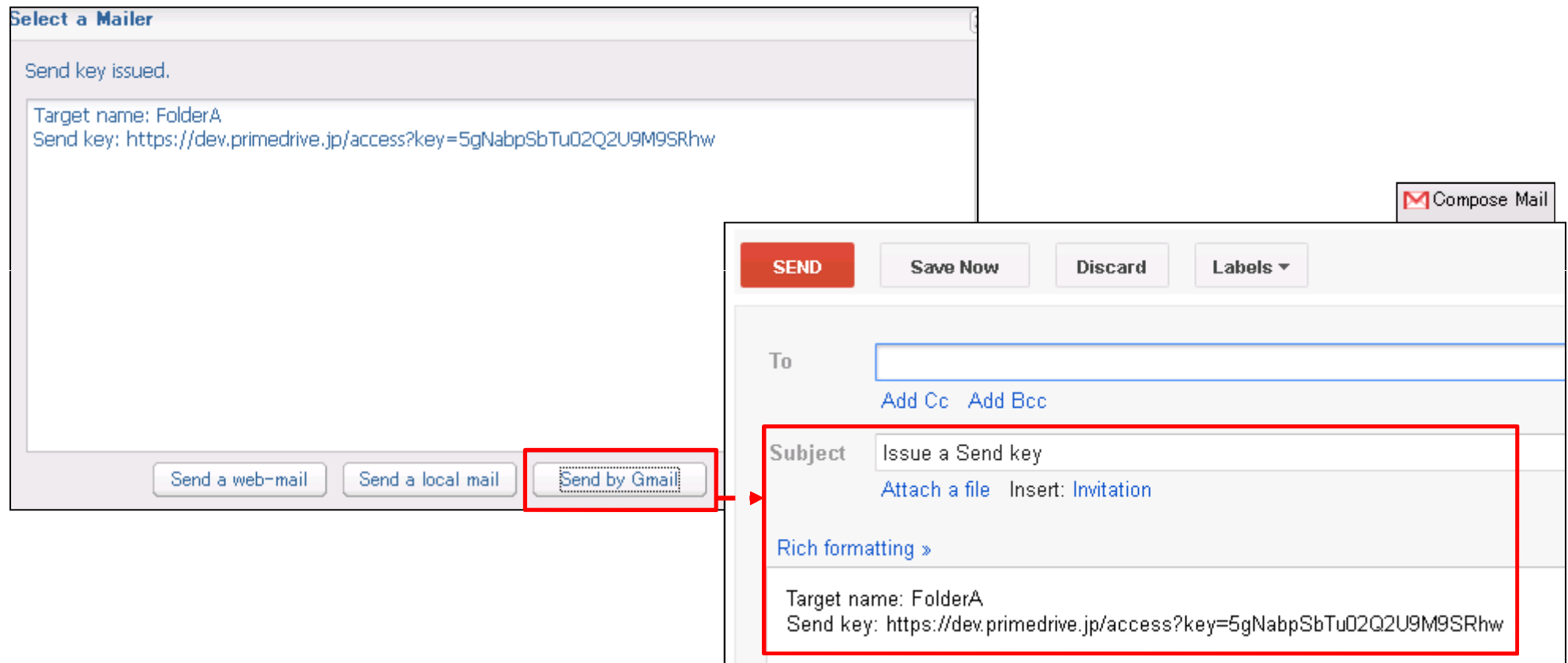

Note: Internet Explorer6 is not supported with using this function.

- We support for Chinese character on file name on PrimeDrive.

<Ex>

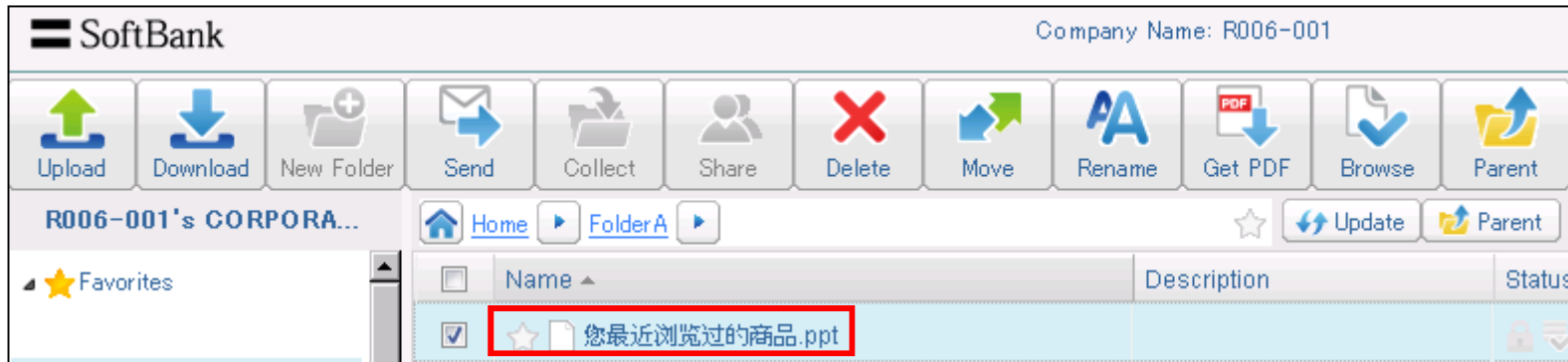

【Note: When downloading files】

- When you download files from PrimeDrive, they are formatted to zip file. If the file which can not be formatted to zip file is included, file name inside of the zip file is corrupted to “?”

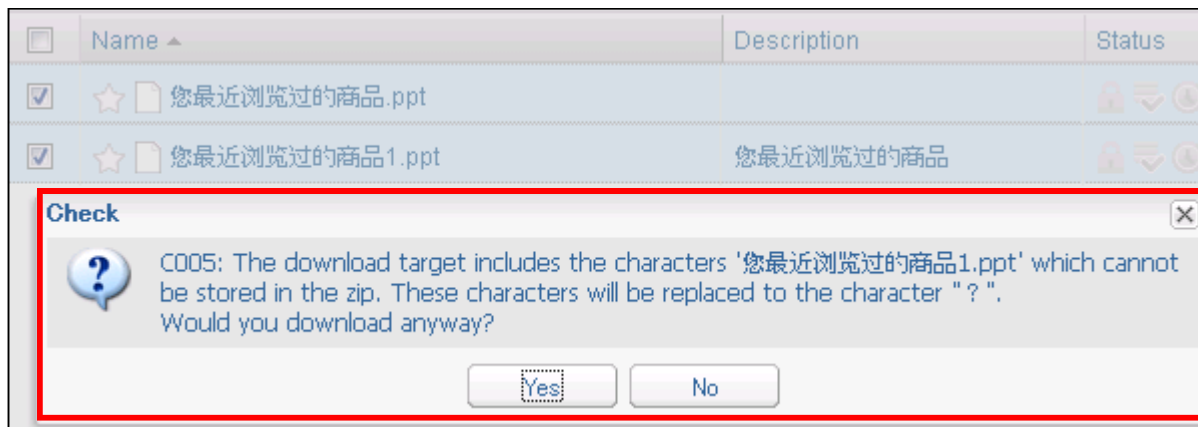

- Reciever's email address and user name to send key can be recorded in log file <Ex>

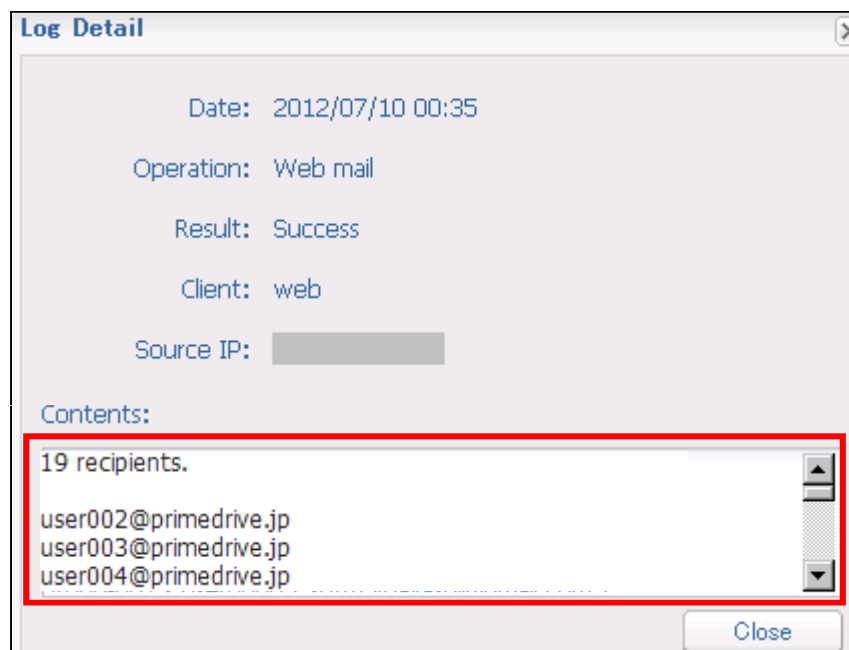

- Log records is listed maximumly 1000 on screen. All log records can be downloaded with csv form.
- Contractor can use this function. Contractor see the box is empty.

User account/ Email notification can be sent by “TO”

- Email notification can be sent by “TO”

Compose

Destination user/group	Destination user/group	Type
	R006-001's user0002(user0002)	Standard user
	R006-001's user0004(user0004)	Standard user

Destination address: Add from Address Book

Send by BCC

* Please separate by comma "," or semi-colon ";" if you are entering multiple address.

* The message will be sent as TO if this is unchecked. (Please note that all destination email addresses will be displayed to the recipient of the mail)

* Contractor users cannot send via TO. (please send via BCC)

Subject: Share setting completion notification

Body: Share setting has been completed.

Share Name: FolderA
URL: https://dev.primedrive.jp/browse#R006-001&1LOZvbGRlckFAKFIwMDYtMDAxKQ==

[How to use]
- Login and click [Shared folders] then you can see the specified Share names.
- By clicking the URL above, you can also see the specified Shared folders

Send Cancel

Not check in the box to send email notification by “TO”.

from: R006-001's CORPORATE MANAGER yoshinori.hayashi@
to: R006-001's user0002 <sbtm.yhayashi@ > ,
R006-001's user0004 <user@gmail.com>
date: Fri, Jul 13, 2012 at 2:15 PM
subject: Share setting completion notification

Note: Contractor user can't send the email notification by “TO”. The check box become to not clickable.

- "Read+Send" and "Read and write+Send/Collect" is added for new preset.

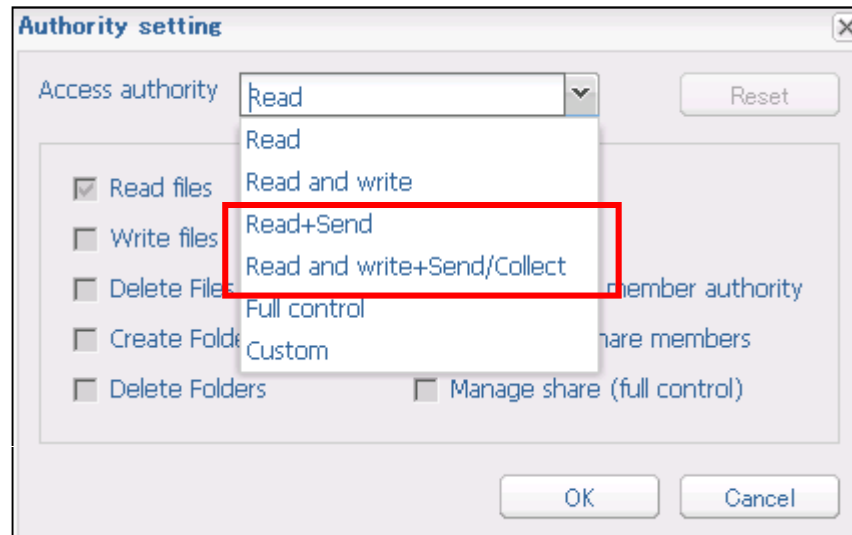

- **Sender's email address of automatic email notification changed to primedrive.jp.**

【Current domain name】

No-reply@tm.softbank.co.jp

【New domain name】

No-reply@primedrive.jp

【Email notification】

- **File time limit setting**
- **Capacity Warning**
- **Password Lifetime**
- **Uploading from Collect Key**
- **Password for Send Key (Automatically generate)**
- **Password for Collect Key (Automatically generate)**
- **Downloading from Send Key**
- **Creating New User**

EOF